

Office SF = 1,282
 Warehouse SF = 3,535
 Total RSF = 4,817

NOTE:
 Overlying grid is 2' x 2'
 Not to scale.

 Air Conditioned Area

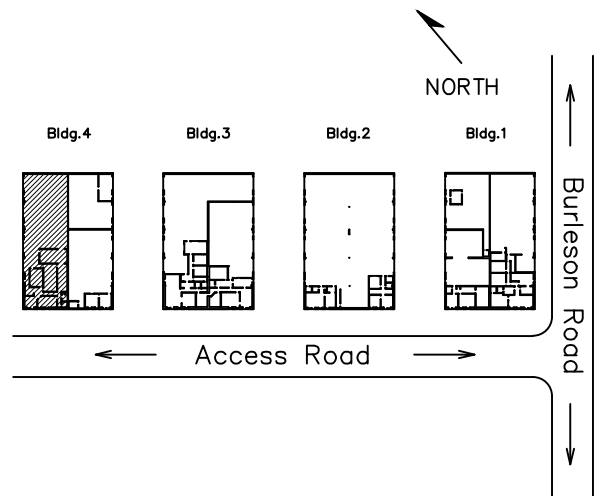

PARK LAYOUT

Drawing for:
 L.H. LAYNE COMPANY
 404 W. Powell, Ste. 202
 Austin, Texas 78753
 Ph: 252-9900 Fax: 252-9902

SUITE 406
 OMNI BUSINESS PARK
 7303 Burleson Rd.
 RENTABLE AREA: 4,817 S.F.

THE MEASUREMENTS AND FLOOR PLANS ARE ACCURATE TO WITHIN 2% INTERIOR WALLS AND DEMISING WALLS ARE ASSUMED TO BE 5" THICK.
 Project No.: 20306.03
 Date: February 18, 2016
 ©2016

DIMENSIONS
 FLOOR PLANS
 www.dimensionsfloorplans.com
 Austin, Texas
 Ph: 342-0114 Fax: 342-1965