

Available December 2016

Central Park North

Building 500

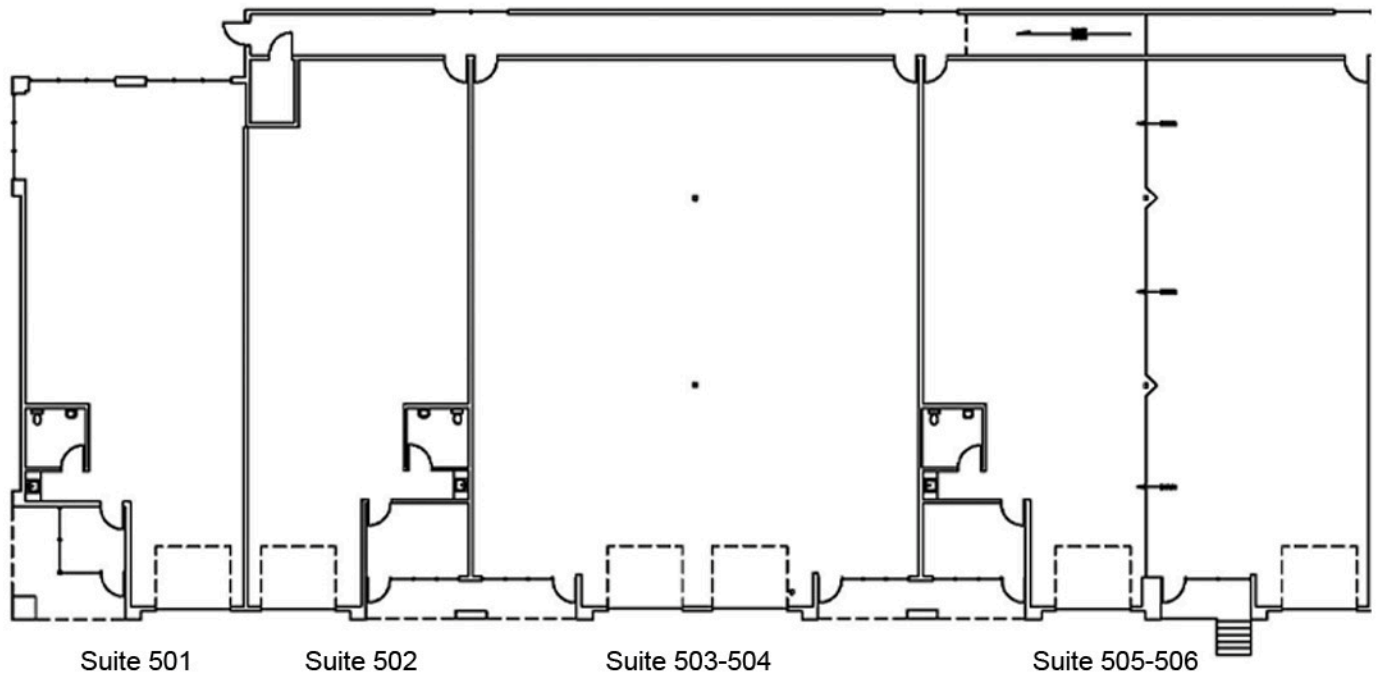

- SUITE 501** - \$2,130.06mo - 2,372sf (82sf OFFICE), 1 GRADE LEVEL DOOR
- SUITE 502** - \$2,095.03mo - 2,333sf (153sf OFFICE), 1 GRADE LEVEL DOOR
- SUITE 503-504** - \$3,352.49mo - 4803sf (NO OFFICE), 2 GRADE LEVEL DOORS
- SUITE 505-506** - \$4,566.52mo - 4817sf (602sf OFFICE), 1 DOCK LEVEL DOOR, 1 GRADE LEVEL DOOR, 2 OFFICES



- Can configure as one space-14,325sf.
- Leases are NNN.
- Rates listed are gross amount.

Contact Eric Layne, CCIM
512-252-9900
eric@laynecompany.com

visit our website for
other available properties:
www.laynecompany.com