

Office SF = 139  
 Warehouse SF = 2,399  
 Total RSF = 2,538  
 Loft SF = 443

NOTE:

Overlying grid is 2' x 2'  
 Not to scale.

 Air Conditioned Area

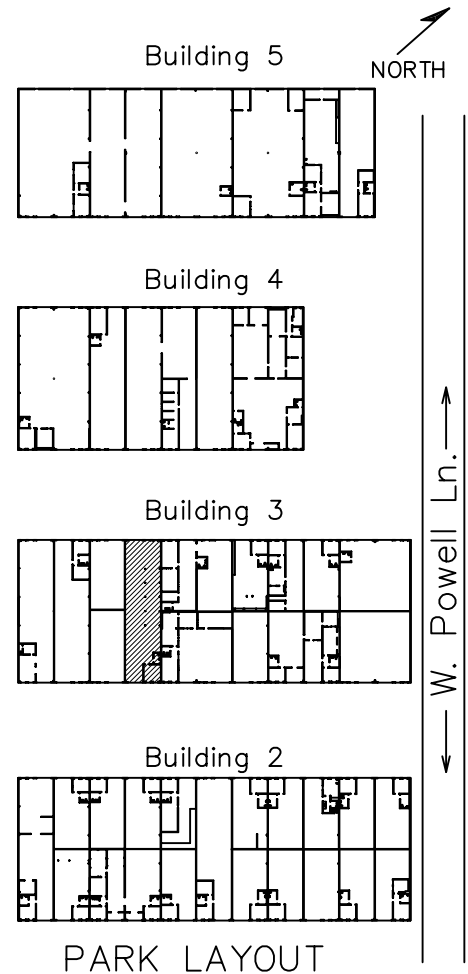

Drawing for:  
 L.H. LAYNE COMPANY  
 404 W. Powell, Ste. 202  
 Austin, Texas 78753  
 Ph: 252-9900 Fax: 252-9902

SUITES 308/315  
 AUSTECH BUSINESS PARK  
 501 W. POWELL LN.  
 RENTABLE AREA: 2,538 S.F.

THE MEASUREMENTS AND FLOOR PLANS ARE ACCURATE TO WITHIN 2% INTERIOR WALLS AND DEMISING WALLS ARE ASSUMED TO BE 5" THICK.  
 Project No.: 20306.01  
 Date: April 15, 2003  
 ©2003

† DIMENSIONS †  
 FLOOR PLANS  
 4412 Spicewood Spgs. Rd., Ste 803  
 Austin, Texas 78759  
 Ph: 342-0114 Fax: 342-1965