

Office SF = 0  
 Warehouse SF = 1,227  
 Total RSF = 1,227

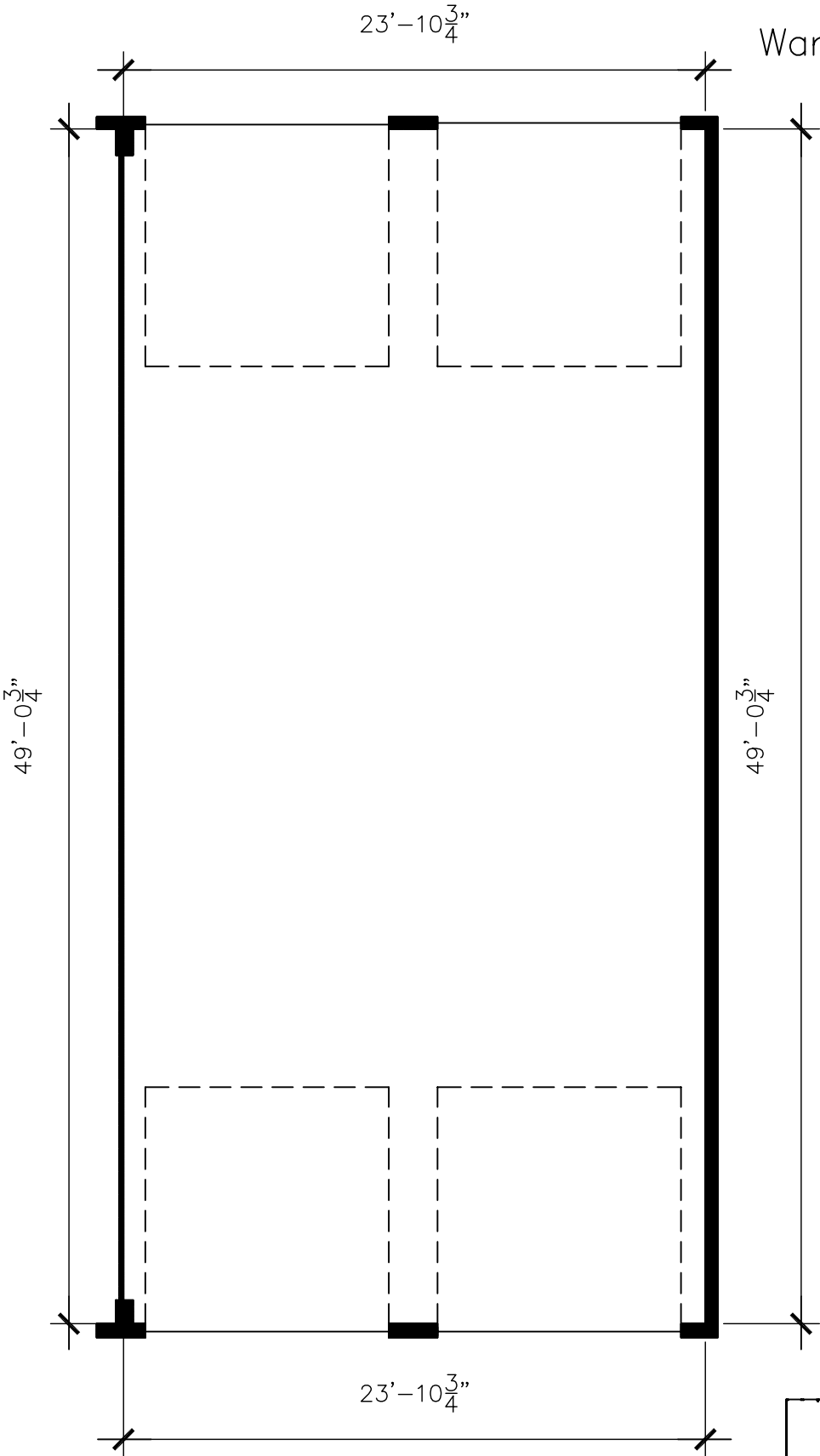

NOTE:  
 Overlying grid is 2' x 2'  
 Not to scale.

 Air Conditioned Area

  
 NORTH

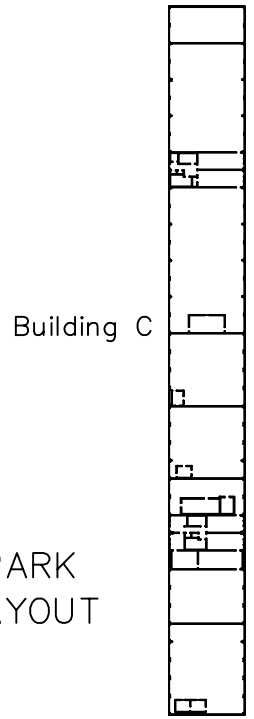

← Howard Lane →

Drawing for:  
 L.H. LAYNE COMPANY  
 404 W. Powell, Ste. 202  
 Austin, Texas 78753  
 Ph: 252-9900 Fax: 252-9902

BLDG. B SUITE 1-2  
 HOWARD ROUTE CENTER  
 1120 W. HOWARD LN.  
 RENTABLE AREA: 1,227 S.F.

THE MEASUREMENTS AND FLOOR PLANS ARE ACCURATE TO WITHIN 2% INTERIOR WALLS AND DEMISING WALLS ARE ASSUMED TO BE 5" THICK.  
 Project No.: 20306.06  
 Date: May 16, 2003  
 ©2003

† DIMENSIONS †  
 FLOOR PLANS  
 4412 Spicewood Spgs. Rd., Ste. 803  
 Austin, Texas 78759  
 Phone: 342-0114 Fax: 342-1965